

There is no exception to the rule because I am never what I have

The theatre should provide the following rooms and equipment, including props

Stage

- Minimum space for the stage: 12m by 12m
- Black dance floor. Important: the floor has to be laid in the width (left to right / see plan)
- Ideally a small backstage space opening on the stage, equipped as a small black box (see plan). Other options have to be discussed.
- A circulation should be possible between backstage space and stage

Lights

- A full front wash focused on the whole stage in lee 203 / 20 profiles 1 kw in two rows / 10 channels
- a diffuse open light atmosphere in the whole room including audience / 20 asymmetric floods 1 kw no colour + 216 (white diffusion) / 10 channels
- A back wash realised with 20 pars 64 CP62 in R114 on one row / 10 channels
- lighting of the small backstage blackbox:
 - 3 front profiles in lee 152 + R132 (quarter hamburg frost) / 3 channels
 - 2 PC 1kw side in lee 176 + R132 (quarter hamburg frost) / 2 channels
 - 2 PC 1kw top in lee 152 + R132 (quarter hamburg frost) / 2 channels
 - 1 profile 2kw front in lee 202 + R132 (quarter hamburg frost) / 1 channel
- Audience light controlled from the lightboard
- lightboard allowing to program linked cues and sequences
- 1 roll of black wrap and 1 roll of alu tape

Sound

- 2 cd players
- mix board with 4 stereo outputs
- 2 full range speakers in the back of the stage
- 1 front PA complete
- 2 independent subwoofers
- 1 monitor onstage with long cable (wedge type)



Props and other material

- 1 red sofa (see photo and dimensions, it should be in the same style and roughly this size) + 2 assorted big red cushions
- 1 simple black foldable chair
- 20m white cotton rope 8mm diameter
- 15 rolls of paper tape (as used for painting work) 4 cm wide

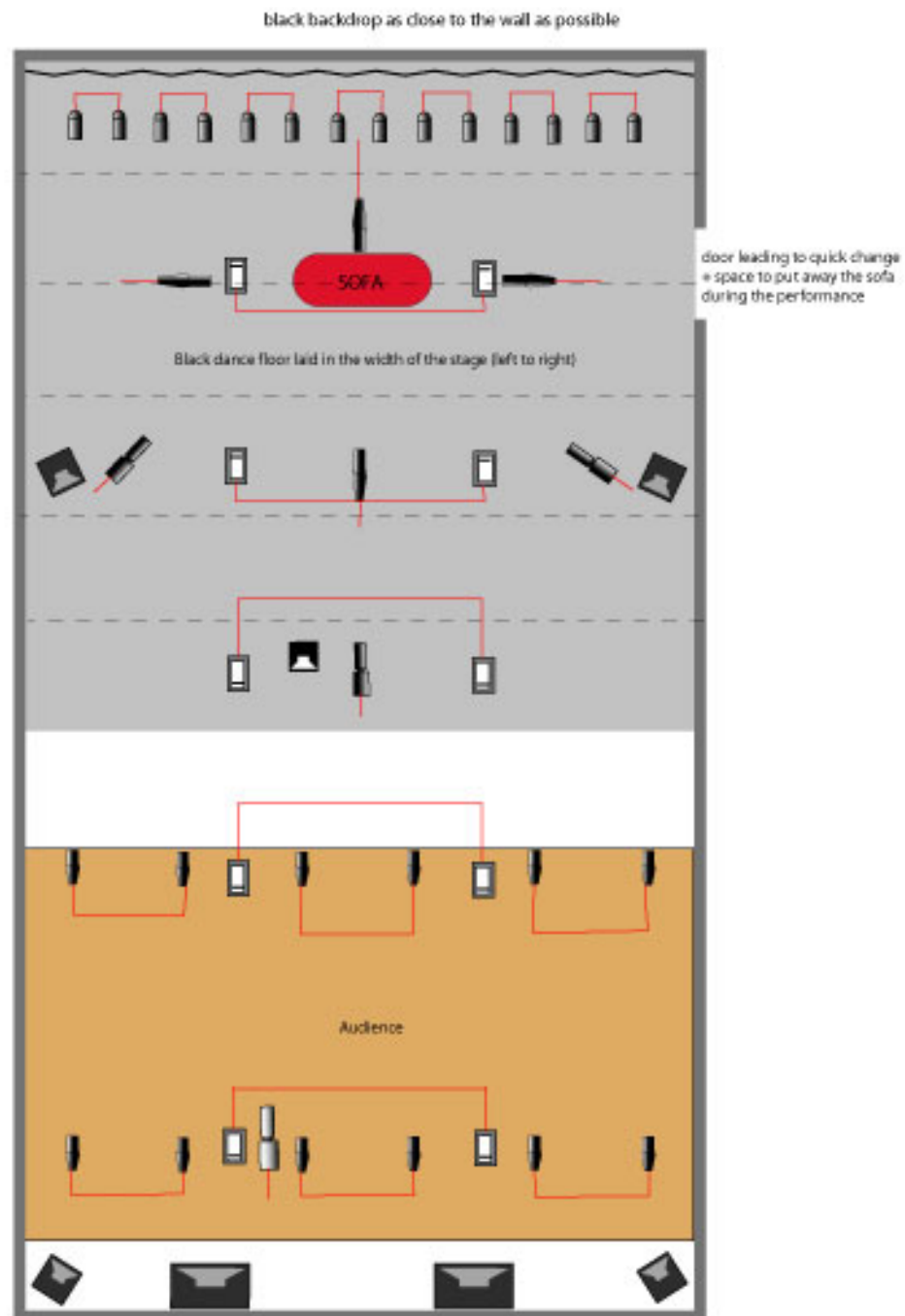
"THERE IS NO EXCEPTION TO THE RULE BECAUSE I AM NEVER WHAT I HAVE"
 Contact: Bruno Pocheron / 0176 223 71 565 / bpmmonkey68@gmail.com



-  14 Pars 62 CP 64 / lee 061 + R114 / 7 channels
-  12 ETC source 4 profiles 36° / lee 203 + R119 / 6 channels
-  4 ETC source 4 profiles 26° / 2 in lee 152 + R132 and 2 in lee 176 + R132 / 4 channels
-  3 profiles Julliat 614S 1KW / 2 in lee 152 + R132 and 1 in R132 / 3 channels
-  1 profile Julliat 714S 2KW / lee 202 + R132 / 1 channel
-  10 asymmetric floods 1kw / lee 251 / 5 channels

-  4 full range speakers hanging from the grid
-  2 subwoofers under the tribune
-  1 sound monitor (wedge) on the floor with a long cable

